



8 Cotswold Ave Castle Hill NSW

4 🏠 2 🚗 2 🚗

Welcome to a realm of unparalleled grandeur and limitless possibilities! Nestled on a sprawling 1139 square meters of prime land, this magnificent family home stands as a testament to luxury, space, and unparalleled potential. Located in a secluded and private enclave, this property promises a lifestyle of tranquility and exclusivity.

Price : \$ 2,050,000
Land Size : 1139 sqm
View : <https://www.onlinerealestateagents.com.au/sale/nsw/hills/castle-hill/residential/house/7917425>

The sheer size of this estate sets it apart in a league of its own, offering a vast canvas for your dreams and aspirations. With expansive grounds that stretch as far as the eye can see, the property beckons those with a vision to develop, extend, and create their own personal haven. The potential is boundless, providing the canvas for you to sculpt the home of your dreams.

As you enter the estate, a sense of grandeur embraces you, offering a retreat from the hustle and bustle of the



Majid Mokhtari
0400657657



Mahsa Abedi
0474 336 736

8 Cotswold Avenue, Castle Hill

4 Bed 2 Bath 2 Car



Internal : 161m²
External : 34m²

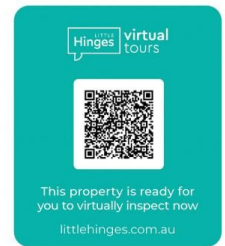

FLOOR PLAN



All information contained herein is gathered by Little Hinges. Whilst the scanning technology is highly reliable, we cannot guarantee its accuracy and interested parties should rely on their own enquiries.

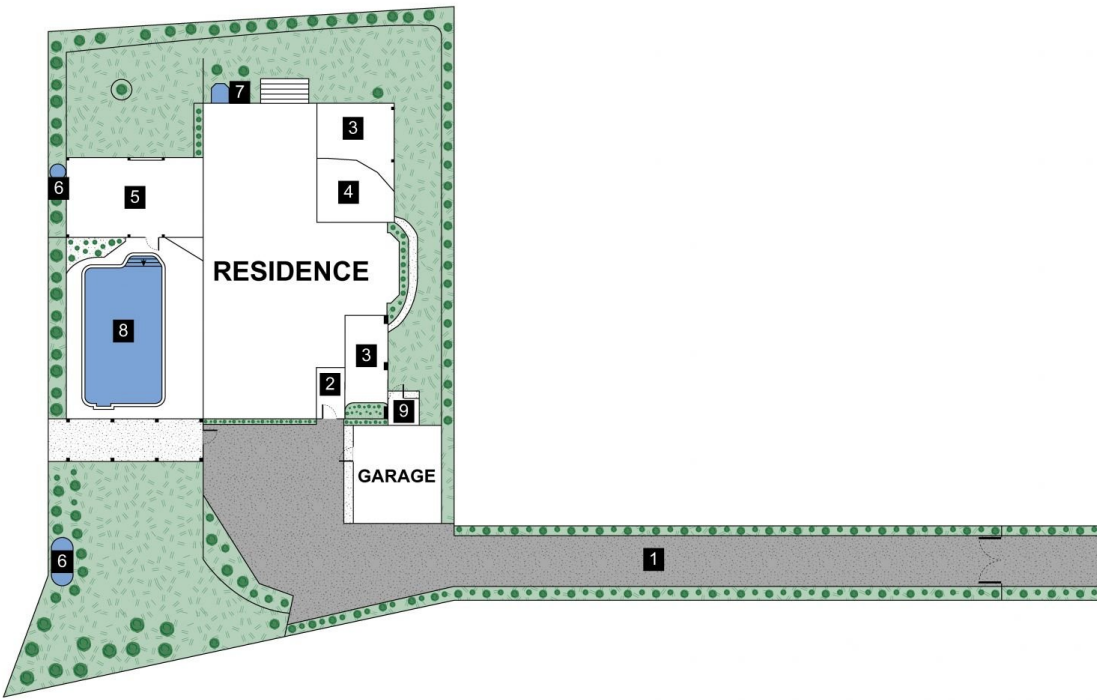

LEGEND

- 1. Driveway
- 2. Porch
- 3. Patio
- 4. Covered Patio
- 5. Deck
- 6. Water Tank
- 7. Hot Water Tank
- 8. Pool
- 9. Cage
- 10. Clothes Line

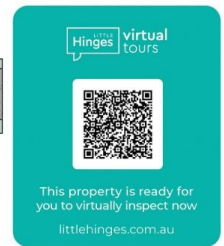

SITE PLAN



All information contained herein is gathered by Little Hinges. Whilst the scanning technology is highly reliable, we cannot guarantee its accuracy and interested parties should rely on their own enquiries.