



4B Wolseley Grove Zetland NSW

3 3 2

Welcome to urban sophistication in this north-facing 3-bedroom, 3.5-bathroom terrace, centrally located in Zetland. Embrace the abundant natural light and warmth as the residence basks in a sunlit northern exposure. The spacious interior, adorned with modern finishes, provides a massive internal size, ensuring a comfortable and stylish living experience. The thoughtful design extends to ample storage solutions, enhancing the practicality and functionality of this premier home. With a double lock-up garage and a prime location, this residence encapsulates contemporary living at its finest.

Price : Contact Agent

View : <https://www.onlinerealestateagents.com.au/sale/nsw/eastern-suburbs/zetland/residential/terrace/7824371>



Majid Mokhtari
0400657657



Mahsa Abedi
0474 336 736

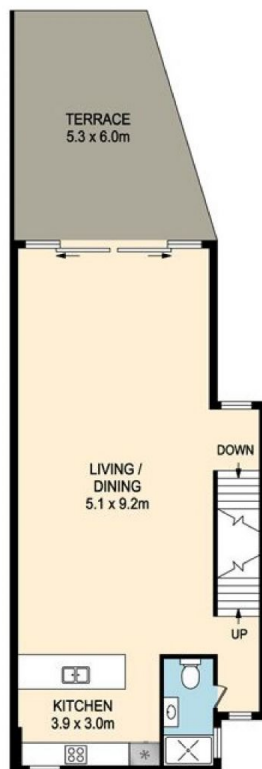
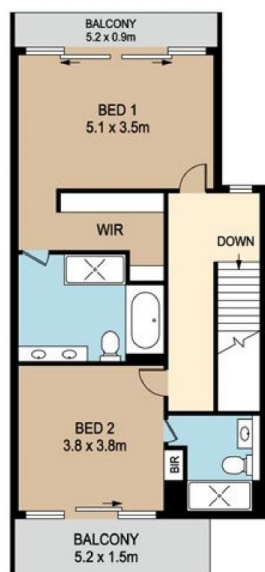

4B WOLSELEY GROVE, ZETLAND

DISCLAIMER : PLANS SHOWN ARE FOR MARKETING PURPOSES ONLY. ALL DIMENSIONS ARE APPROXIMATE AND NOT TO SCALE. THEY ARE SUBJECT TO ERRORS AND INACCURACIES AND NO LIABILITY WILL BE ACCEPTED. INTERESTED PARTIES SHOULD MAKE THEIR OWN INQUIRES.

