

18/29-37 Epsom Road Rosebery NSW

2 1

Positioned on a corner of the third level, this security apartment boasts an elevated perspective with panoramic views from all sides, delivering an exquisite blend of natural light, seamless indoor-outdoor living, and distinctive architectural elegance that sets it apart within the complex. Spanning two levels, its interiors are thoughtfully designed for contemporary, stylish living, relaxation, and entertainment in a rapidly evolving neighborhood that continues to flourish.

- Effortless flow from the streamlined living and dining areas to the sun-drenched balcony
- A well-appointed Smeg gas kitchen featuring sleek stone countertops and a convenient dish drawer
- The primary bedroom boasts a built-in wardrobe and floor-to-ceiling glass windows, providing abundant natural light

View : <https://www.onlinerealestateagents.com.au/sale/nsw/eastern-suburbs/rosebery/residential/apartment/7735752>



Majid Mokhtari
0400657657



Mahsa Abedi
0474 336 736

Unit 18, 29-37 Epsom Road, Rosebery

2 Bed 1 Bath

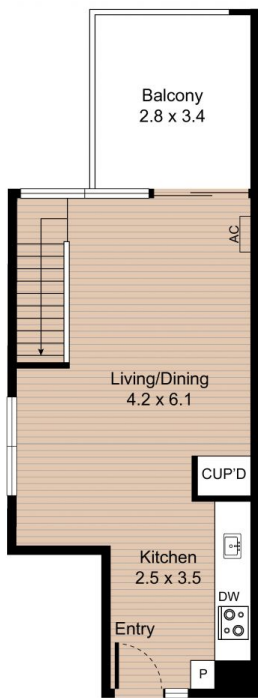

THIRD FLOOR

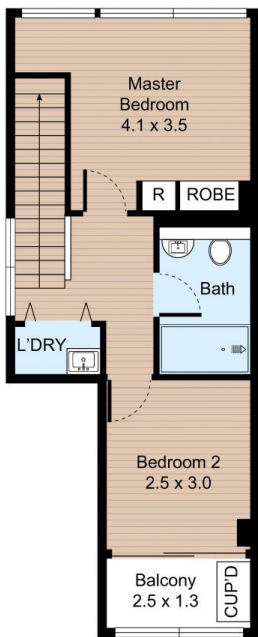

FOURTH FLOOR

Internal : 64m²
External : 13m²



All information contained herein is gathered by Little Hinges.
Whilst the scanning technology is highly reliable,
we cannot guarantee its accuracy and interested parties
should rely on their own enquiries.