



## 131 Sutherland Street Paddington NSW

3 2

Discover the epitome of urban living at this remarkable residence, nestled in a highly coveted location that pulsates with energy and excitement. Immerse yourself in a world of unparalleled convenience, as this exquisite haven is ideally situated just steps away from an array of vibrant shops, Edgecliff Centre, Train station, Tennis Court

Prepare to be captivated by the irresistible allure of this remarkable address, where modernity meets sophistication in perfect harmony. From the moment you step foot into this enchanting abode, you'll be greeted by a symphony of luxurious amenities and exquisite design elements that seamlessly blend together to create a haven of opulence.

Unwind in the plush comfort of your spacious living quarters, meticulously crafted to cater to your every need. The sleek, contemporary interiors exude an air of elegance,

**Land Size** : 127 sqm

**View** : <https://www.onlinerealestateagents.com.au/sale/nsw/eastern-suburbs/paddington/residential/terrace/7643419>



**Majid Mokhtari**  
0400657657



**Mahsa Abedi**  
0474 336 736

# 131 Sutherland Street, Paddington

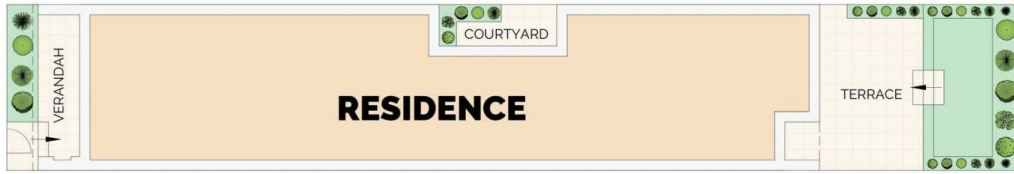

SITE PLAN (NOT TO SCALE)

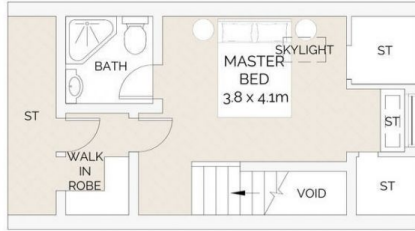

FIRST FLOOR



GROUND FLOOR



Scale in metres. Indicative only. Dimensions are approximate. All information contained herein is gathered from sources we believe to be reliable. However we cannot guarantee its accuracy and interested persons should rely on their own enquiries.